

JUNCTION City Schools  
ENGAGE - INSPIRE - EDUCATE

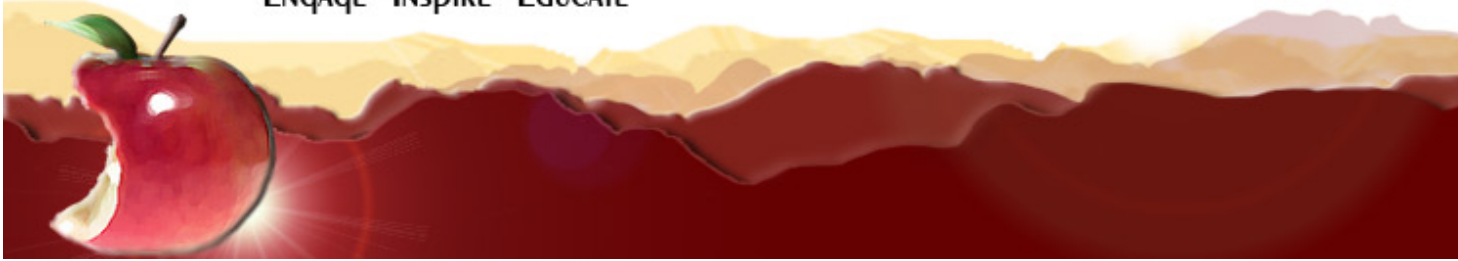

February 22, 2016  
Long Range Facility Planning

# Facilities Committee Final Report



# The Committee

Speakers: Mark Steinmetz and Judy Kazmierkoski

## Additional Participating Committee Members

*Debbie Adams*

*Dan Alley*

*Daniel Allred*

*Chris Bolton*

*Tony Ceniga*

*Jessica Cook*

*Alison Covey*

*Judy Croce*

*Erin Curtis*

*Krista and Dustin Dawson*

*Shelly and Luke Dickson*

*Tom Endersby*

*Don Fisher*

*Susie Freeman*

*Kirk Gebb*

*Jacque Gerdes*

*Angie Gibson*

*Scott Gibson*

*April Hodgson*

*Diane Hogan*

*Stacey Johnson*

*Jody Kister*

*Mara Liechty*

*Dina Marschall*

*Steve McKinley*

*Malcolm McRae*

*Judy and Chris Meyer*

*Tina Nash*

*Laura Ohman*

*Denise and Mike Pratt*

*John Reerslev*

*Kathleen Rodden-Nord*

*Brady Sheppeard*

*Lisa and Rob Silbernagel*

*Mark Steinmetz*

*Frank Taylor*

*Jackie and Andy Terrien*

*Linda VanOrden*

*Wendy Waddell*

*Glen Wheadon*

*Willard Wisegarver*

*Melissa Wood*

*Brian Young*



# The Planning Process

- Workshop 1—Discovering (3/30/15)  
*Process, existing data, goals, big idea*
- Workshop 2—Exploring (4/20/15)  
*Budgets and impacts, prioritized needs*
- Workshop 3—Formulating (5/13/15)  
*Plan options into a draft plan*
- **COMMUNITY SURVEYING**
- Workshop 4—Finalizing (10/28/15)  
*Review Surveys and Adjust Plan*
- Workshop 5—Adjusting (1/13/16)  
*Adjustments based on property analysis*



# The Plan

PHASES				PROJECT NAME	TOTAL PLAN PHASES			
1	2	3	4		2016	2020	2026	2030
<b>NEW CONSTRUCTION</b>								
X				HS Phase 1 (CR & Media Hub)	\$11,778,000			
	X			Laurel School Replacement ROM*		TBD		
		X		HS Phase 2 (CR, Science, Office) ROM*			TBD	
			X	HS Phase 3 (Phys Ed and Arts) ROM*				TBD
<b>CRITICAL CAPITAL NEEDS</b>								
X				<b>District-Wide Safety &amp; Security</b> Vestibules, Classroom Doors, Card Locks & Electronic Systems	\$1,410,000			
X				<b>Oaklea MS - HVAC System</b> Primary Equipment and Controls	\$855,000			
X				<b>Territorial Pavement</b> Driveway and Front Parking	\$295,000			
X				<b>Territorial Covered Shelter</b> 52' x 50' Pre-Fab Metal Open Bldg.	\$223,000			
X				<b>District-Wide - Minor ADA Work</b> Ramps & Restrooms	\$74,000			
<b>FUTURE CAPITAL NEEDS</b>								
		X		Building Investments ROM*			TBD	
			X	Building Investments ROM*				TBD
<b>Phase Options Total Budget</b>					<b>\$14,635,000</b>			

\*ROM - Rough Order Magnitude - more firm pricing to be determined in those future phases



# Junction City HS

## Phase 1 - \$11,778,000

### Phase 1

- Construct a new 2-story classroom wing with 14 classrooms with Central MEP Plant
- Construct a new media center that will also serve as a Technology Lab, Student Commons / Hub and Support Community Functions
- Move Counseling & AD Offices to Pitney Center
- Demolish Southern portion of East Wing and old small shop
- Mothball program areas in Northern portion of East Wing leaving corridor for safe access to auxiliary gym & science



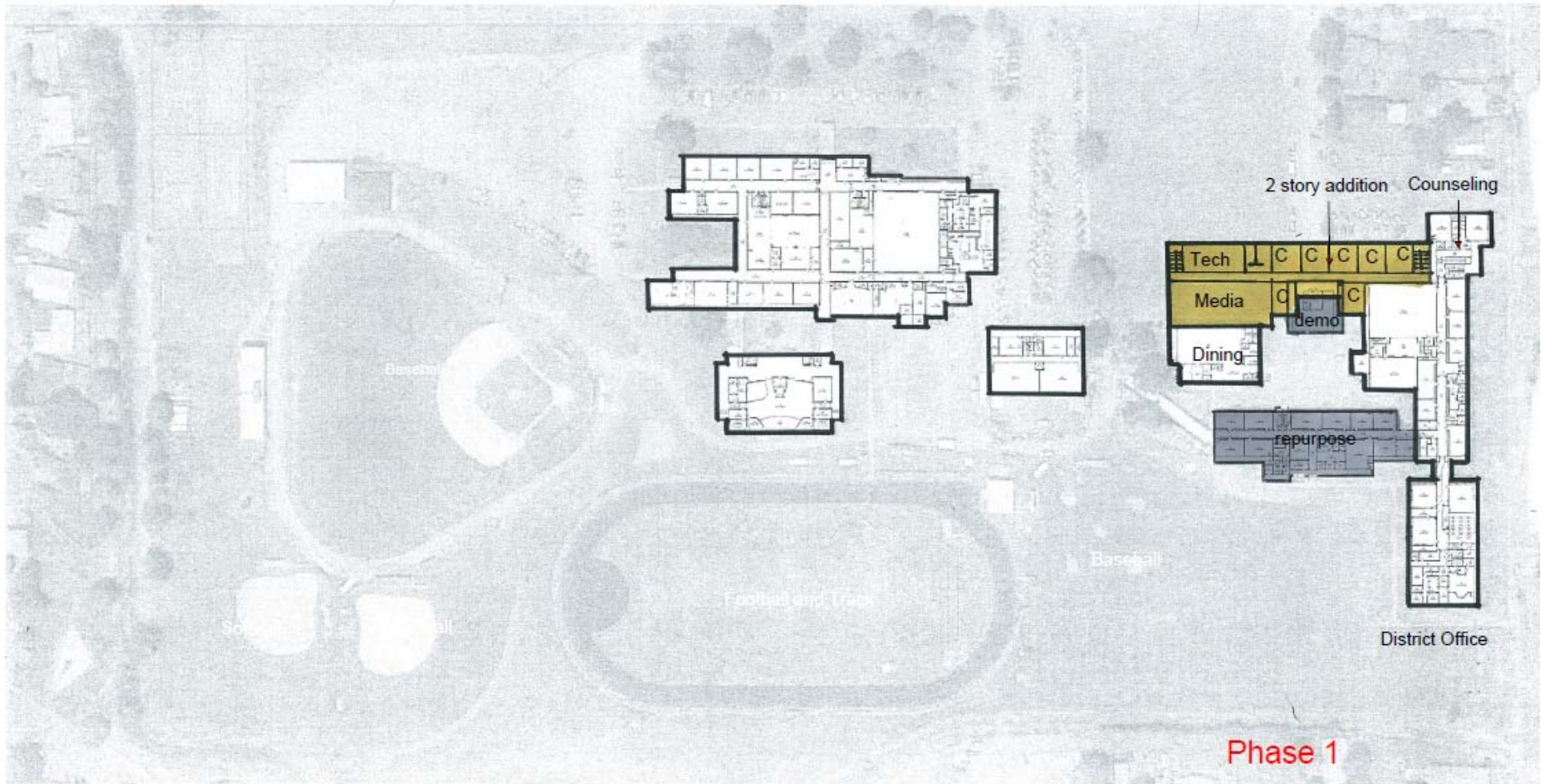

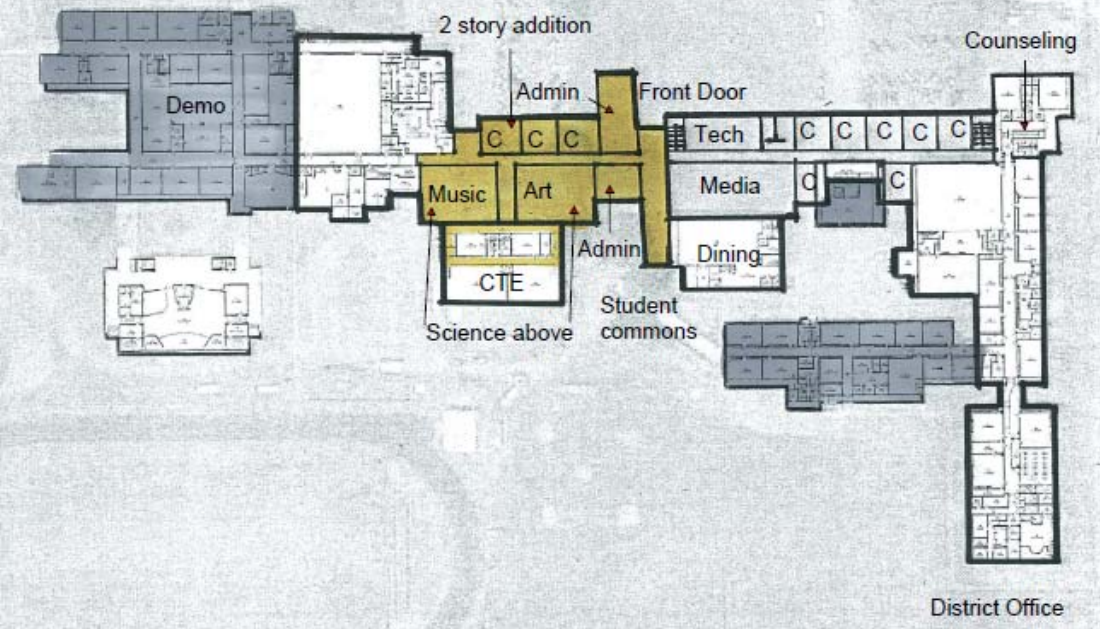

Phase 2

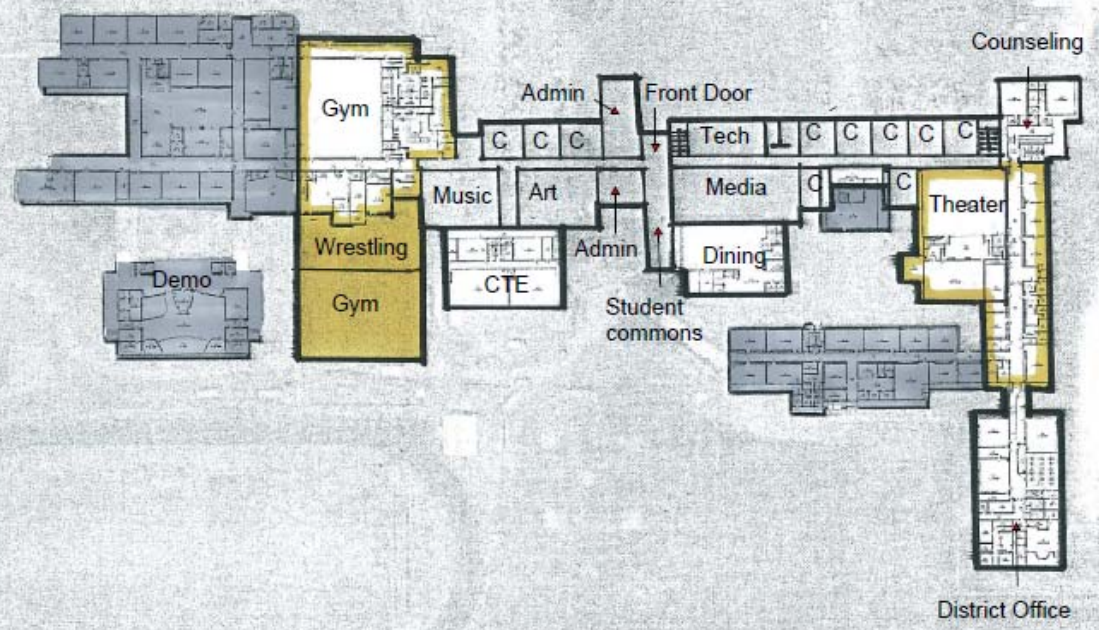

Phase 3



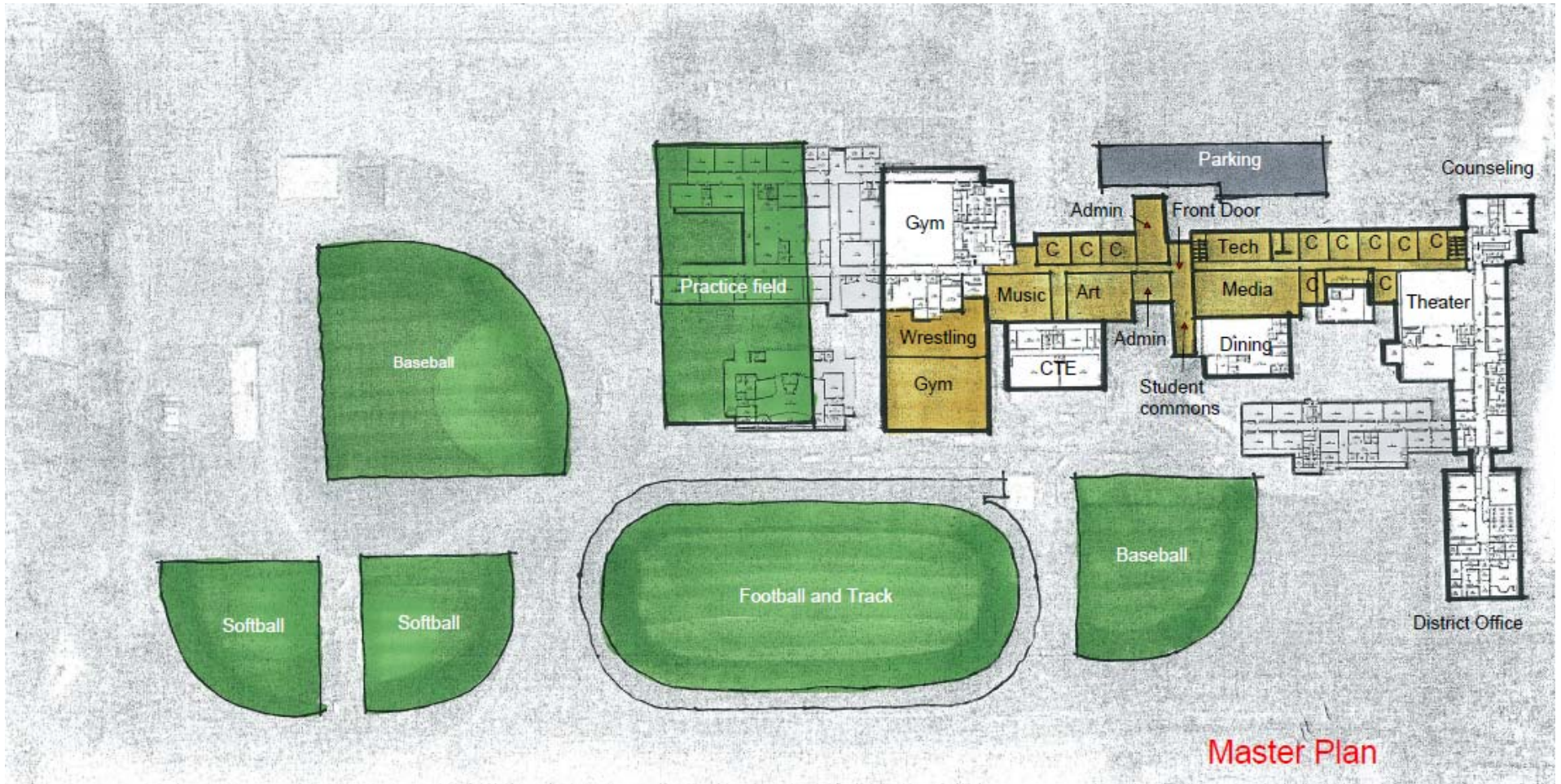



# District-Wide Safety & Security - \$1,410,000

## Vestibules

Inclusion of interior partitions and doors interlocked with a security system to control entry outside of drop off and arrival times to channel visitors through the front office.

## Classroom Doors

Provide at all instructional spaces door locks that lock from the interior of the classroom

## Card Locks

Provide a universal card swipe system at primary exterior doors, door position sensors at all exterior doors, and auto lock down systems tied to these openings and cross-corridor doors.

## Electronic Systems

Replacement or upgraded phone and public address systems, cameras at primary locations, and intrusion detection at primary equipment locations.





# Oaklea Middle School HVAC System- \$855,000

Mechanical System Investment will target:

Equipment replacement at the end of its useful life

Direct Digital Controls upgrades throughout

Retro-commissioning of localized and zone equipment including air volume and plumbing controls. Replacement and refurbishment of these items are included in the budget.





# Territorial Elementary Site Work - \$518,000

## Replacement of Asphalt Paving

Removal and replacement of the front asphalt pad and the front access drive (currently in failure). Replacement includes sub-grade, surfacing, striping, and storm drainage control.

## Addition of a Covered Play Shelter

Includes the provision of a 52' x 50' metal structural with 4 basketball hoops, striping, lighting, and storm water control





# District-Wide Minor ADA Work - \$74,000

Based on the 2008 Assessment Report to Include:

Restroom Upgrades – Modifying restroom accessories in respect to grab bars, toilet and sink clearances, and mirrors

Exterior Door Improvements – Replacing overhead closers and door handles, and modifying thresholds to provide compliant transitions





# Next Steps

- Board to Receive the Committee Recommendation
- Adoption of Board Resolution (March 7<sup>th</sup>)
- Adoption of Bond Title (March 7<sup>th</sup>)
- Creation of Informational Campaign Calendar (see handout)
  - FAQ
  - Renditions of Primary Elements (JCHS Addition, Territorial Shelter)
  - Scheduling Community and Contractor Meetings
  - Preparation of Presentation Materials & Handouts
- Separate (non-District) creation of PAC